

simply

Building a Braai

You can buy barbecues in every conceivable shape and size from any number of different outlets, but if you are serious about barbecuing and enjoy your DIY, what could be more satisfying than building your own? The materials that make up this barbecue are relatively expensive and it will last for years.

**TOOLS REQUIRED**

Tape Measure
Spirit Level
Square
Bricklaying Trowel
Chisel
Club Hammer

Building made simple!

simply Building a Braai

Make a wooden frame to act as a template guide to the dimensions of the grill kit. Lay the bricks out dry (without mortar) to enable the correct brickwork bond to be determined. Bed the bricks on a bed of mortar made up of 5 parts soft building sand to one part of cement, with plasticiser added to keep the mix supple.

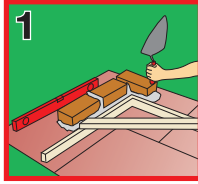

Use a spirit level to ensure the brickwork is level and plumb. Here, a paving slab is being used to act as a tabletop. Lay the slab down as a guide to the independent leg position. You can use a 1 x 0,6m paving slab, or a 0,6 x 0,6m slab like this one.

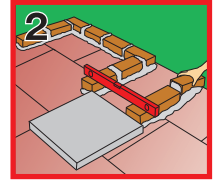

To get the brickwork bond correct, it is necessary to cut half bricks. Cut these on a soft surface with a bolster chisel and club hammer. Wear protective clothing for this operation.

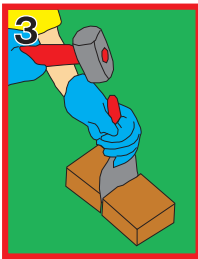

When you have built the brickwork to the correct height for the slab table, turn some of the bricks as shown, so that they act as corbels (supports) for the table and the grate. Ensure that you measure the width of the grate so that you will be sure of a good fit once the grate is in place in the finished barbecue.

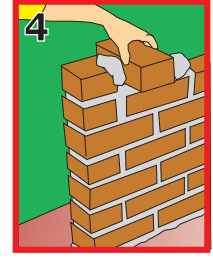

Repeat the corbels two courses up to support the cooking griddle. Again, measure the position of these carefully.



Two more courses of bricks are required to complete the barbecue.

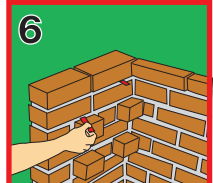

Option :
Push four metal pins into the mortar below the top course of brickwork to support a warming griddle shelf.

Set the paving slab on a bed of mortar to make a table top alongside the main body of the barbecue. Leave the brickwork to cure for a couple of hours.

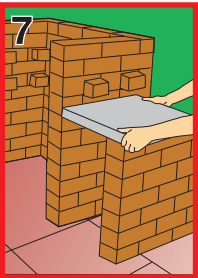

The area under the slab can be used to store wood/charcoal.

SHOULD YOU HAVE ANY FURTHER QUESTIONS, PLEASE DO NOT HESITATE TO CONTACT YOUR LOCAL BUILD IT STORE.

REGIONAL OFFICES

KWAZULU NATAL 031 508 5000 **EASTERN CAPE** 041 404 5000 **WESTERN CAPE** 021 550 7300 **N A M I B I A** 09264 61 214201

SWAZILAND 031 753 6800 **SOUTH RAND** 011 821 4000 **NORTH RAND** 011 203 5300 **LOWVELD** 013 753 6800

© 2006 BUILD IT

E & O. E.